

SUBJECT TO SITE SURVEY, CONFIRMATION OF LEGAL BOUNDARIES, SITE CONSTRAINTS & HIGHWAYS

**ALDI FOODSTORE**  
 PROPOSED 1,801 SQM (GEA)  
 PROPOSED 1,716 SQM (GIA)

WAREHOUSE AREA 347sqm (NET)  
 AMENITY AREA 115sqm (NET)  
 RETAIL AREA 1,254sqm (NET)

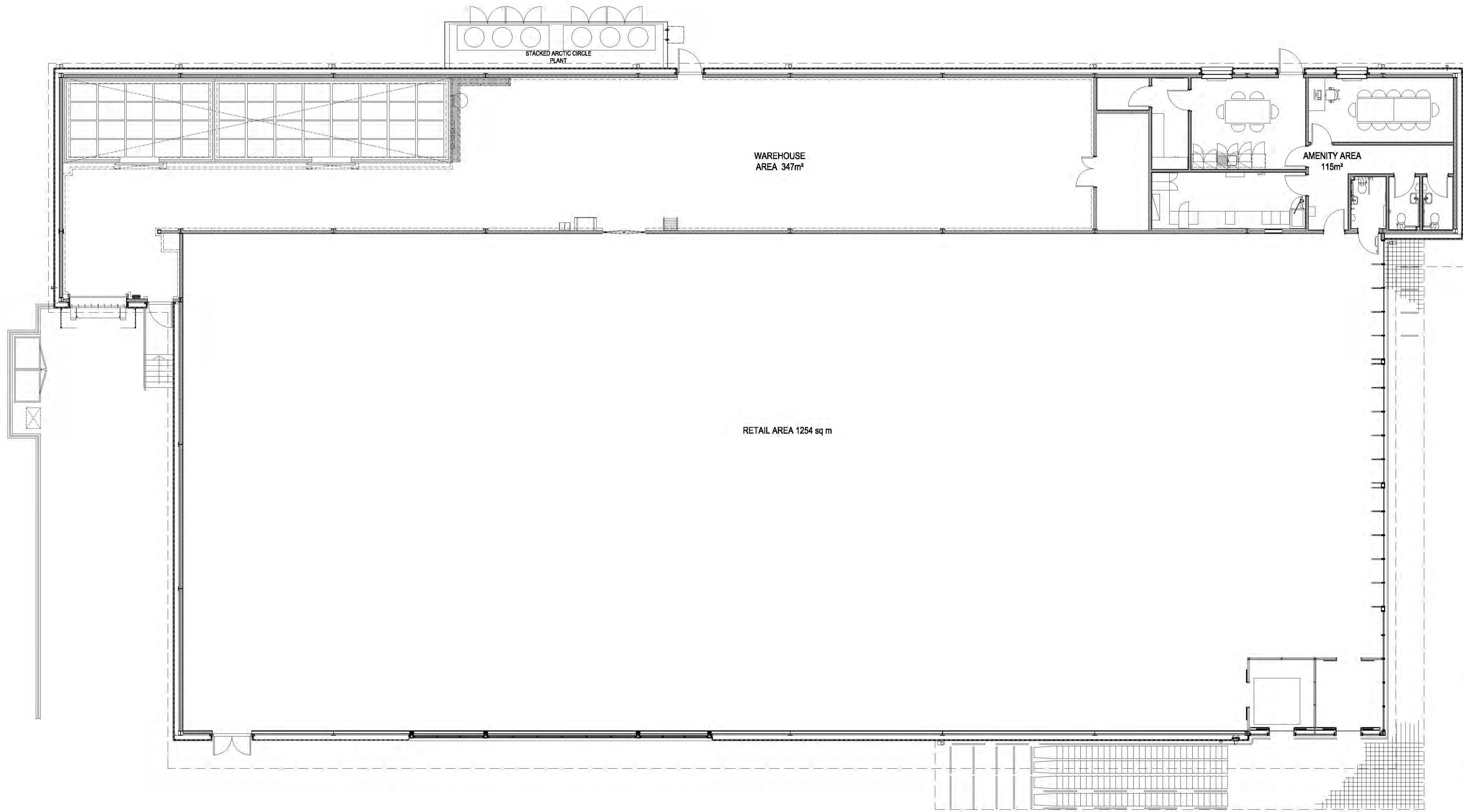

Rev	Date	Description	Rev By	CHK'd By
A	01/10/18	GIA & GEA FIGURES UPDATED	JPG	



Project Title: Ekco Business Park  
 Priory Crescent  
 Southend on Sea  
 SS2 6PP

Client: ALDI STORES LIMITED - CHELMSFORD

Status: PLANNING

Scale: 1:100 Drawing Size: A1

Date: 17/09/2018 Drawn By: JJI Checked: JPG

Drawing Title: PROPOSED FLOOR PLAN

Job/Draw No: 2238-CHE-112 Rev: A

- 2 St. Johns North, Wakefield, WF1 3QA 1. 01924 291800
- Carvers Warehouse, 77 Dale Street, Manchester, M1 2HG 1. 0161 2988555
- The Old Factory, 79 High Street, Newport Pagnell, MK16 6AB 1. 01908 211577
- 101 London Road, Reading, RG1 5BT 1. 0118 9507700
- 10 Green Court, St Christophers Place, London, W1U 1JJ 1. 0207 4091215

